

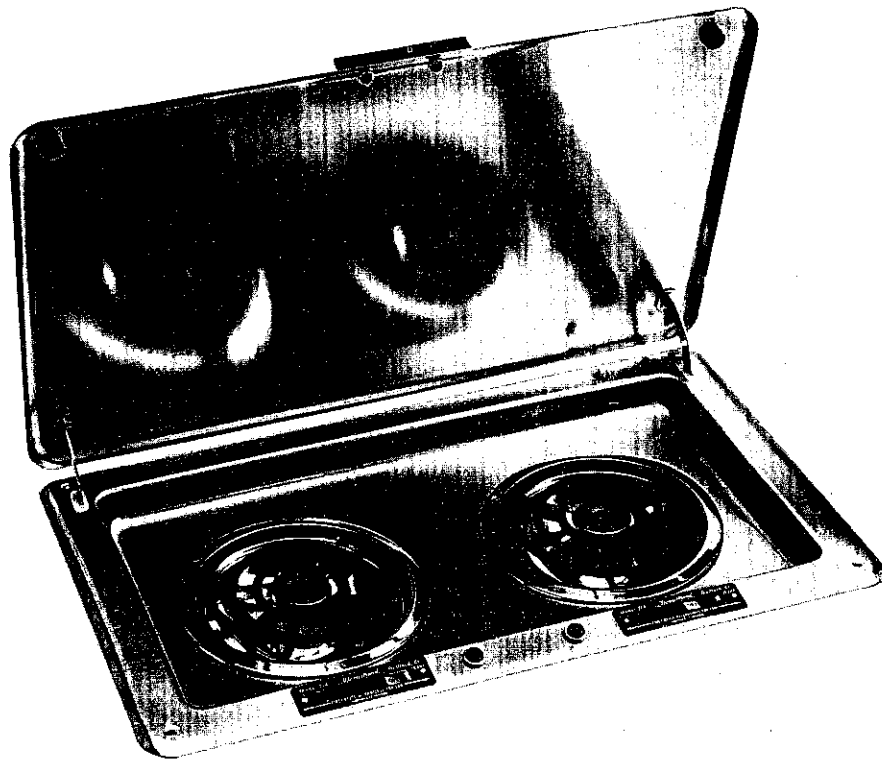

AN INTERNATIONAL MARINE INDUSTRIES COMPANY

2 BURNER ELECTRIC STOVE, MODEL 214 OPERATING AND INSTALLATION INSTRUCTIONS



TWO BURNER RECESSED
ELECTRIC STOVE
MODEL 214

PLEASE KEEP THIS MANUAL ABOARD YOUR BOAT

Kenyon Marine

INTRODUCTION

Kenyon Marine stoves have been engineered exclusively for marine use. The design considerations and the materials used were dictated by the requirement for a reliable, long life and low maintenance stove, operating in a salt atmosphere.

The operating instructions which follow are for the Model #214 two burner electric galley stove. It is Marine Underwriters Lab. listed, File Number ME4.

INSTALLATION

Installation should comply with applicable standards of the ABYC and/or the "Fire Protection Standards for Motor Craft," NFPA #302.

Cutout: A cutout with dimensions shown below is required. Make sure there are no obstructions beneath the countertop within two inches behind the

edge of the cutout where the rear of the stove is to be located.

Also check that the total countertop thickness does not exceed $13/16"$. Draw lines on countertop as indicated to help center the stove after inserted.

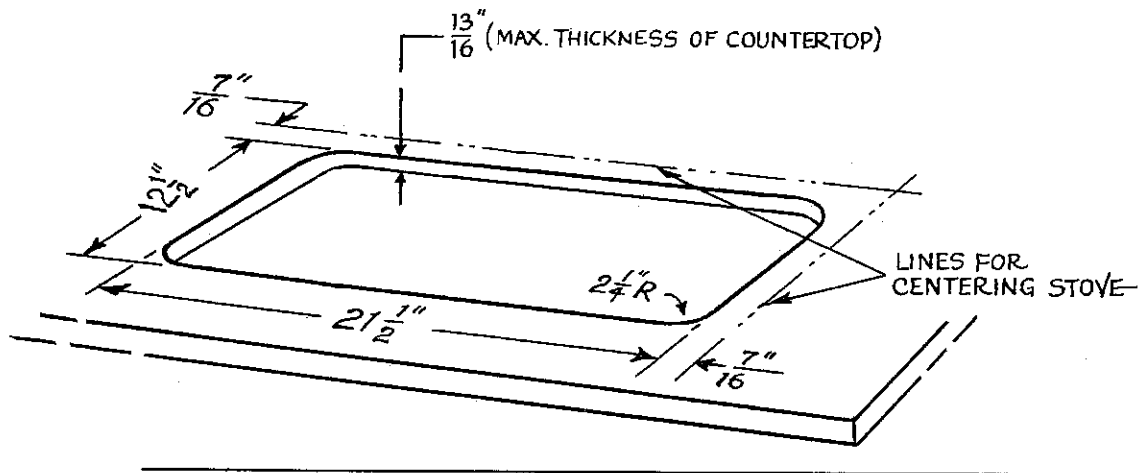

STOVE INSTALLATION

Open stove lid to locked position and bring stove to either end of cutout. Raise stove end furthest from cutout so that stove is slanting, and slide lower end into cutout. Care should be exercised so as not to damage the control wheels.

Center the stove with help of the lines already drawn on the countertop. Mark the centers of the four fastening holes. Remove stove in the same manner as inserted. Drill four holes with $3/32"$ (.093) drill diameter. Re-install stove and secure in each corner with #6 x $3/4"$ oval head wood screws.

NOTE: Before stove is secured, a slight bowing may be noticeable on the flanges. This is an intentional design feature to provide a tight seal around the flange once the stove has been tightly secured in each corner.

ELECTRICAL DATA:

115 V AC

Power Consumption: 2200 watts total
Supply Wire #12

Use #12 3-wire Type SO or Type ST rubber insulated cable from separate circuit of boat's power supply and connect to terminal board on the front of stove.

It is recommended that the supply conductors be protected with a double pole simultaneous trip circuit breaker rated at 20 amperes.

Remove plate covering terminal board. Connect the ungrounded current carrying conductor to terminal marked L₁, the neutral current carrying conductor to terminal marked L₂, and connect ground wire (green) to the left terminal block mounting screw (double nut).

A cable clamp is provided to secure cable. Replace cover after all connections have been made.

OPERATING INSTRUCTIONS

The control wheels, partly protruding thru the front rim of the stove, provide infinite variation of the heat.

The control "Off" position is with the wheel moved left as far as it will go.

Moving the wheel right from the "Off" position a "click" can be felt at which time the indicator light goes on. This is the position for high heat. Turning further to the right the heat is gradually lowered until the wheel stops, at which point approximately 20% of high heat is delivered.

There is a safety lid shut off switch located in the right rear frame, which will turn off the burners if the lid is accidentally closed with them on.

CLEANING STOVE

CAUTION: TURN OFF THE POWER AT THE SUPPLY SOURCE BEFORE SERVICING OR CLEANING THE STOVE.

The stove is easy to keep clean as the electric elements may be removed. To remove elements, make sure they are cold and simply lift them out of the rings. This is done by grasping them by the end opposite from where they extend under the frame and remove with a pulling action. A mild cleaner may be used with a damp (not wet) sponge or rag.

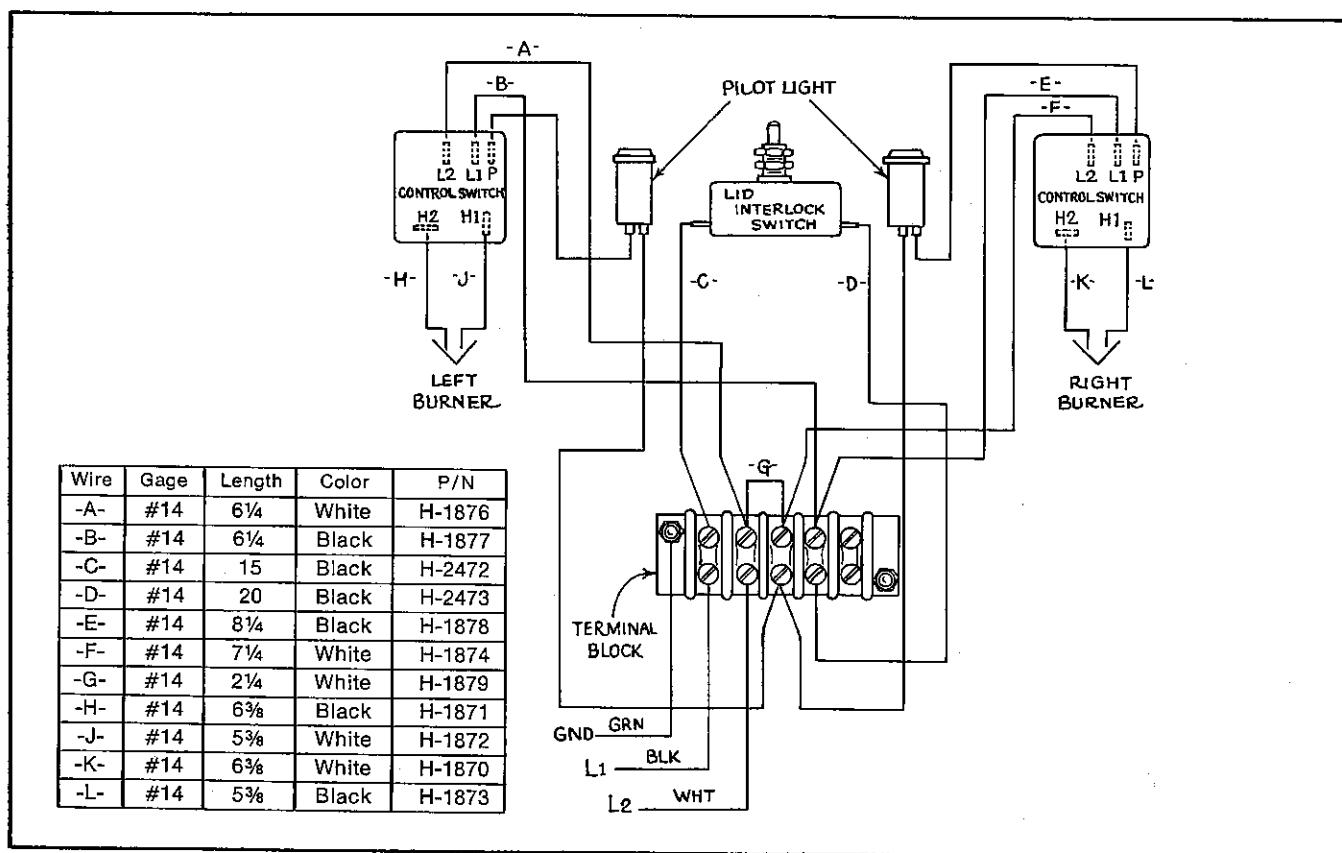

WIRING DIAGRAM

EXCERPTS FROM NFPA NO. 302 - 1972

CHAPTER 4. COOKING, HEATING AND AUXILIARY APPLIANCES

40. Open flame devices are more liable to promiscuous, unskilled or ignorant operation than any other boat equipment involving fire risk. It is therefore imperative that such items be selected and installed with the aim of minimizing personal and physical hazards.

41. Cooking Equipment.

411. Galley stoves shall be manufactured, approved and labeled for marine use. Printed instructions for proper installation, operation and maintenance shall be furnished by the manufacturer. A durable and permanently legible instruction sign covering safe operation and

maintenance shall be provided by the manufacturer and installed on or adjacent to the consuming appliance, where it may be readily read.

(a) Stoves shall be installed in adequately ventilated areas to comply with Paragraph 113.

(b) Stoves shall be securely fastened when in use and when stored.

(c) Any burner system that may affect safety by reason of motion of the boat shall not be used.

(d) All woodwork or other combustible materials above stove tops and all woodwork or combustibles immediately surrounding stoves shall be effectively insulated with noncombustible materials or sheathing.

Kenyon Marine

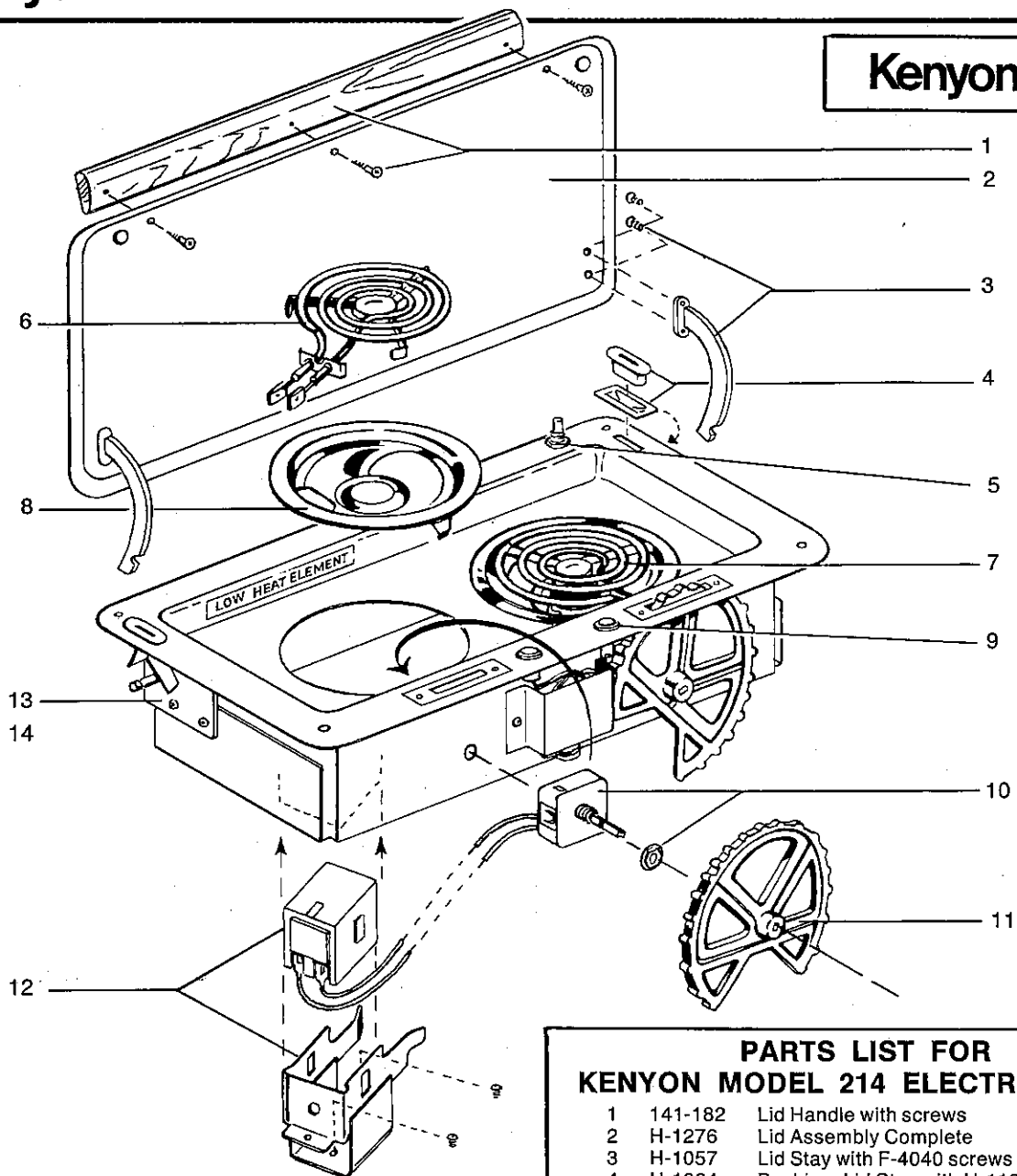

Kenyon	Model 214
---------------	---------------------

PARTS LIST FOR KENYON MODEL 214 ELECTRIC STOVE		
1	141-182	Lid Handle with screws
2	H-1276	Lid Assembly Complete
3	H-1057	Lid Stay with F-4040 screws
4	H-1064	Bushing, Lid Stay with H-1193 Retainer
5	043-200	Lid Switch
6	H-1750	Electric Element 118V, 750W.
7	H-1751	Electric Element 118V. 1100W.
8	H-1821	Burner Bowl
9	H-1758	Light Indicator
10	H-1759	Control Switch 120V. with nut
11	H-1203	Control Wheel with H-1286 Decal "OFF-HI"
12	H-1755	Plug, Element with H-1251 Bracket
13	H-1707	Stay Bracket Assembly, Left
14	H-1708	Stay Bracket Assembly, Right



AN INTERNATIONAL MARINE INDUSTRIES COMPANY

P.O. Box 308, New Whitfield St., Guilford, CT 06437 #203/453-4374 Telex 643804 Kenyon Guilford
1600 East St., Gertrude Place, Santa Ana, CA 92705 #714/557-8104 Telex 182706 Sparcraft IRIN