

*Good Lookin'
Cookin'*

Keny
by Kenyon

OPERATING INSTRUCTIONS

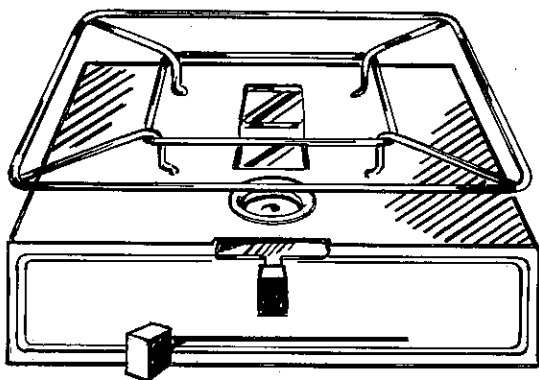

USE WATER ON ALCOHOL FIRES

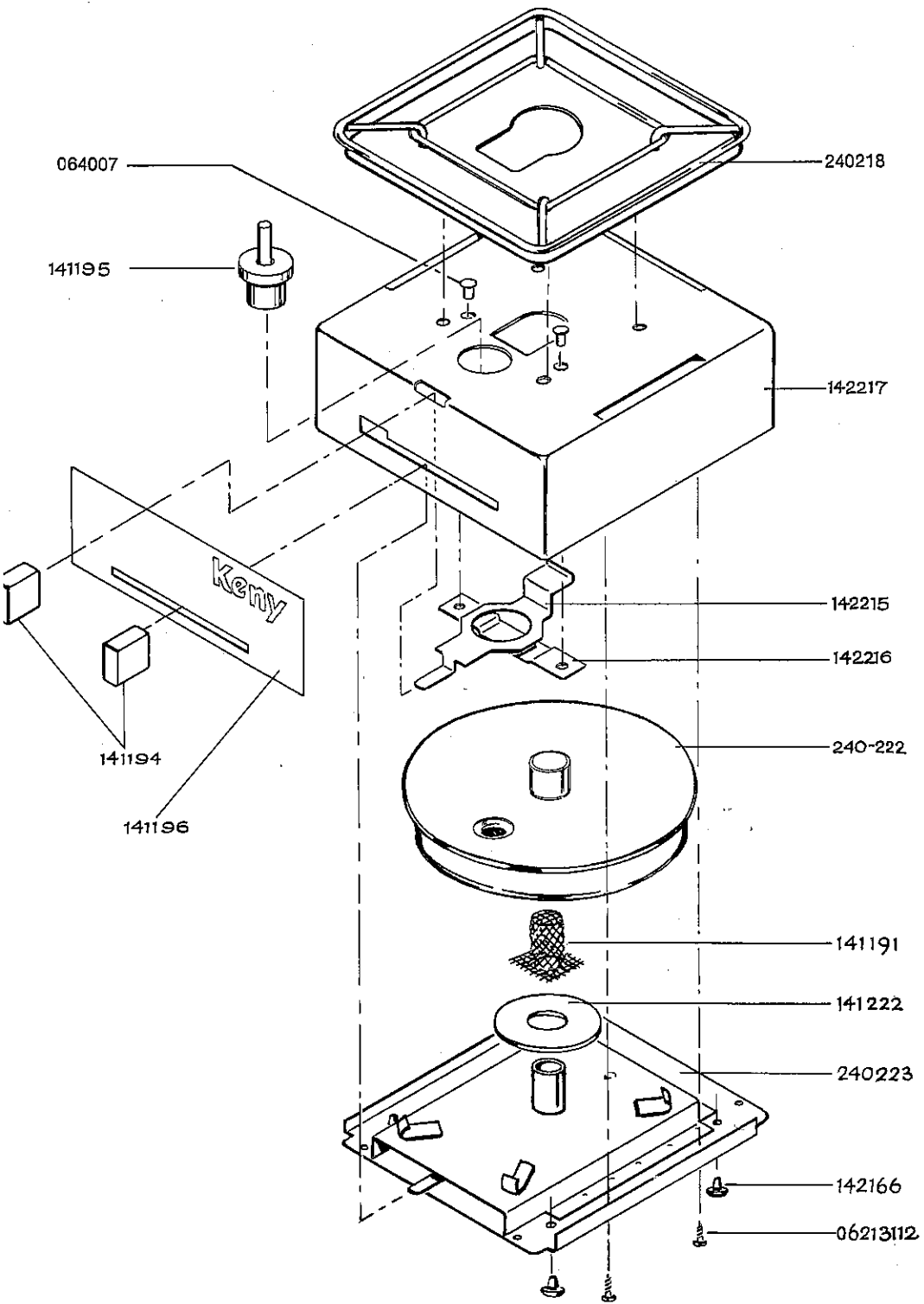

REPLACEMENT PARTS LIST

ORDER BY NAME & PART NUMBER

GRATE	240218
STOVE BODY	142217
SNUFFER	142215
BRACKET	142216
BURNER ASSEMBLY	240222
BOTTOM ASSEMBLY	240223
FEET	142166
SCREW	06213112
FILL PLUG	141195
KNOB	141194
INSTRUCTION LABEL	141196
RIVET	064007
INSULATION (Not Shown)	141250

HOW TO LIGHT THE KENY STOVE

Do not lean over stove while lighting

1. Pull out Snuffer Control. (Top Knob).
2. Slide Temperature Control to ON.
3. Apply lighted match to stack.
4. Slide Temperature Control to adjust flame.

TO EXTINGUISH

1. Slide Temperature Control to OFF.
2. Wait 10-15 seconds.
3. Push in Snuffer Control.

TIPS

1. Do not refuel stove while it is hot. Cool stove 10 minutes before refueling or storing.
2. Do not overfill—use 4 oz. max. of Denatured Alcohol.
3. Do not use in confined area. Provide plenty of ventilation.
4. Do not lean over stove while lighting.
5. Use CAUTION handling hot stove.
6. Do not drop matches into chimney.
7. Do not leave fuel container near stove.
8. Wipe up all spills before lighting stove.

Kenyon

KENY ADD-ON ACCESSORIES

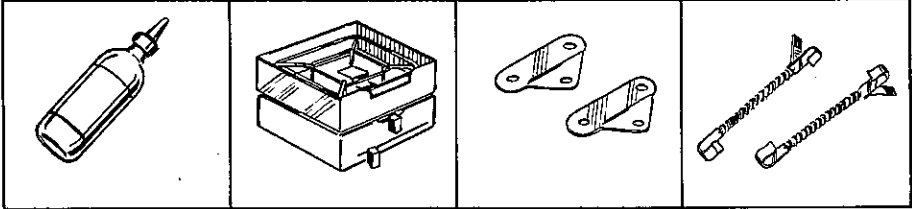

FILL BOTTLE

WIND GUARD

HOLD DOWN
BRACKETS

POT HOLDERS

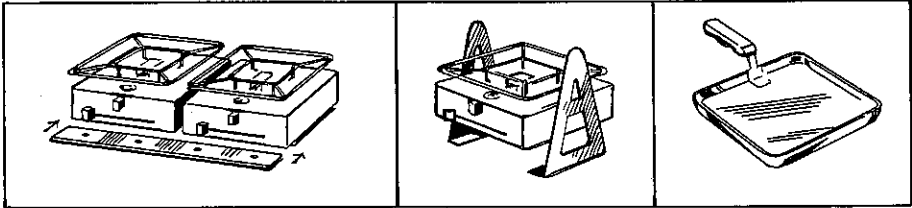

MULTI-STOVE ASSEMBLY KIT

GIMBAL SET

KENY GRIDDLE



a member of Brown Group, Inc.